

Quick Start Guide

Model: STR-FLW8WW



Let's get your new 8 kg front load washing machine ready to use!

A Installing The Machine

CAUTION! This washing machine is extremely heavy – transport it with care! A team lift or mechanical aid is required when moving it.

IMPORTANT! Before installing the washing machine, you must remove the transport bolts from the back of the housing and cover the holes with the transport hole caps provided. The four bolts hold the drum in place during the transport but they must be removed before use so the drum can move during cycles.

This washing machine must be installed by a competent person. Installation involves removing the transport bolts, levelling the machine, connecting it to your cold water supply and installing the drain hose. **For detailed installation instructions, please consult the supplied instruction manual, which also has comprehensive usage instructions and important safety advice.**

NOTE: Make sure the washing machine is properly and securely installed. Before using the washing machine for washing clothes, run a complete cycle without clothes using the drum clean program.

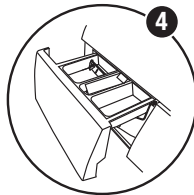
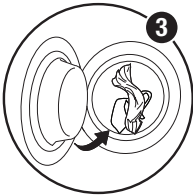
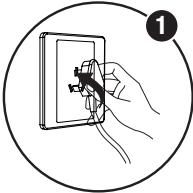

B Preparing The Load

1 Plug in the machine.

2 Open the water tap.

3 Load your laundry items into the washing machine – page 26 in the instruction manual has useful hints to help you with this.

4 Close the door and add detergent to the drawer – find all the details on page 24 in the instruction manual.

C Control Panel Operation

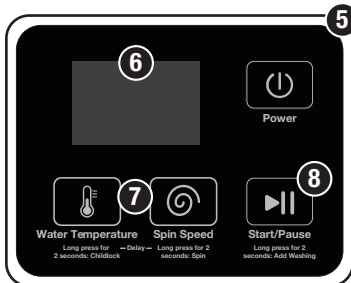

5 Rotate the program dial to switch on the machine, select a program and switch the machine off at the end.

6 The display screen shows the settings, time remaining, options, codes etc.

7 Use the buttons to set a delay start time or extra rinse, or adjust the spin speed and water temperature.

8 Press the start/pause button to start a wash program or to pause it.

Nearly done! Just a bit more on the other side of this page ...

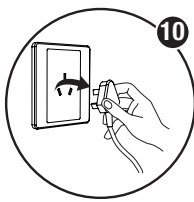
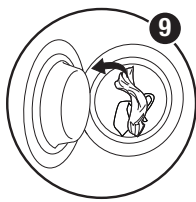

Afterwards

D

When the buzzer sounds you can open the door and take your washing out of the machine. The machine will automatically change into stand-by mode after several minutes of inactivity. Press the power button to turn off the machine.

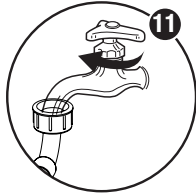

Unplug the washing machine.

Close the water tap.

We recommend you leave the door slightly ajar so the drum can dry properly and to prevent mould and odour development.

E

Wash Programs

Program	Max. Load (kg)	Time (hr:min) (A)	Temp. (°C) (B)	Rinse Times	Spin Speed (rpm)
Mixed	4	1:01/1:16	20/40	2	0/600/800/1000
Intensive (D)	8	3:47	40	3	0/600/800/1000/1200
Cotton	8	1:29/1:49/2:09/2:24	20/40/60/85	2	0/600/800/1000
20°C (C)	3	0:54	20	2	0/600/800/1000
Gentle	3	0:45/1:00	20/40	2	0/600
Wool	3	0:42	20	2	0/600
Night	4	0:54/1:04/1:24	20/40/60	2	0/600
Antibacterial	4	2:00	85	2	0/600/800/1000
Drum Clean	-	1:30	85	2	800
Rinse + Spin	8	0:17	-	1	0/600/800/1000
Spin	8	0:11	-	-	0/600/800/1000
Kids Wear	4	1:12/1:22/1:42/1:57	20/40/60/85	3	0/600/800
Shirts	4	0:56/1:02	20/40	2	0/600/800
Underwear	3	1:13/1:23/1:43	20/40/60	2	0/600
Quick30'	2	0:30	20	2	0/600/800
Quick15'	2	0:15	20	2	0/600/800



Give us a call

What? You mean this Quick Start Guide didn't have ALL the answers? The manual has more comprehensive instructions, or speak to us. Call our **After Sales Support** on **1300 112 534**.

Well done, you made it! Now sit back and relax ... your new 8 kg front load washing machine is automatically covered by a 3 year in home warranty.