



Quick Start Guide

Model: STR-VD8W

Let's get your new 8 kg vented dryer ready to use!

A Installing The Machine

CAUTION! This dryer is very heavy – transport it with care! A team lift or mechanical aid is required when moving it.

This washing machine must be installed by a competent person. Please refer to pages 12–14 in the instruction manual for comprehensive instructions.

NOTE: Before using the dryer for the first time, run a complete cycle with some clean, damp rags before using it on your laundry for the first time. Follow the instructions on page 13 in the manual.

1

Dry in the shade Do not tumble dry

Dry flat Hang to dry Drip dry

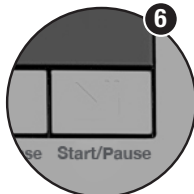
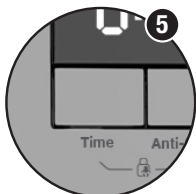
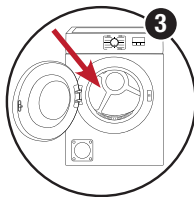
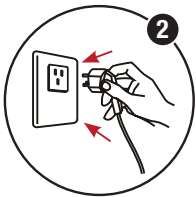

B Preparing The Load

NOTE: Prior to loading the dryer, check that none of the items have the following symbols on them, which indicate that the items are UNSUITABLE for drying.

Plug in the machine.

Load your laundry items into the dryer, page 14 in the instruction manual has useful hints to help you with this.

Close the door

C Drying

Select a program – all program details are provided on page 18 in the instruction manual.

Press the time button to select the 30, 50, 70 or 90 minute drying time.

Once your settings have been configured, press the "Start/Pause" button to begin the cycle. Pause at any time by pressing this button again.

Nearly done! Just a bit more on the other side of this page ...

Afterwards

D

The machine will beep 6 times at the end of the cycle and the word END will show on the display. Open the door and take your washing out of the unit. The machine will switch off after 3 minutes. See page 19 of the instruction manual for more details.

Once the laundry has been removed, set the program selector dial to OFF to switch off the machine.

Unplug the machine after each use.

Ensure the machine is unplugged and cooled before cleaning the lint filter. See page 22 of the instruction manual for more details.

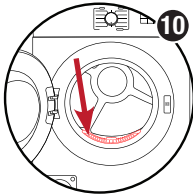
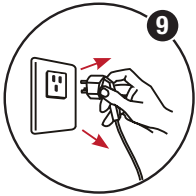

8

9

10

E Drying Programs

See table below for each program and suitable usage descriptions.

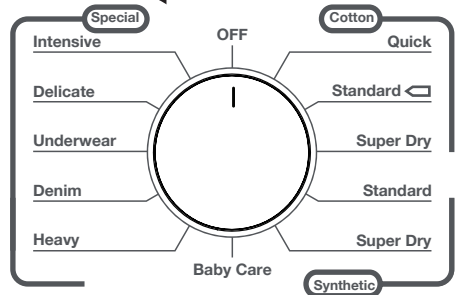

Program	Default Drying Time (min)	Types of Textiles
Cotton Quick	100	Small load of everyday clothing and other items made of cotton fabric.
Cotton Standard	130	Everyday clothing and other items made of cotton fabric.
Cotton Super Dry	140	Everyday clothing and other items made of cotton fabric. This setting will ensure a more thorough dry.
Synthetic Standard	65	Everyday clothing and other items made of mixed/blended fabrics.
Synthetic Super Dry	70	Everyday clothing and other items made of mixed/blended fabrics. This setting will ensure a more thorough dry.
Special Baby Care	60	Baby clothes.
Special Heavy	160	Larger, bulkier items (bedsheets, quilt covers etc.)
Special Denim	70	Denim jeans or leisure clothes that have been spun at high speed in the washing machine.
Special Underwear	60	Underwear
Special Delicate	110	Suits clothing that require a more delicate dry.
Special Intensive	130	This setting will achieve a much higher heat, which will kill off mites and other nasties.



Give us a call

What? You mean this Quick Start Guide didn't have ALL the answers? The manual has more comprehensive instructions, or speak to us. Call our **After Sales Support** on **1300 112 534**.

Well done, you made it! Now sit back and relax ... your new 8 kg vented dryer is automatically covered by a 3 year in home warranty.