



Let's get your new stainless steel dishwasher ready to use!

## A Installing the dishwasher

**CAUTION!** This dishwasher is heavy – ensure you have a helper to move it.

**This dishwasher should be professionally installed by a licensed plumber or dishwasher installer. Do not install it yourself.**

### WHERE TO INSTALL?

This dishwasher is designed for freestanding use, but it can also be recessed under a single benchtop. The back should rest against the wall behind it and the sides along any adjacent cabinets or walls. Position the dishwasher on a level and sturdy floor. If the floor is uneven, adjust the feet until it reaches a horizontal position.

### WATER AND POWER CONNECTIONS

Have the appliance installed close to an existing water inlet and drain connection and make sure there is a power point nearby, or in an adjoining cabinet. The dishwasher's water supply and drain hoses can be positioned either to the right or left sides to facilitate proper installation. Only use the supplied new hoses when connecting this dishwasher to the water supply.

**Please refer to pages 12–15 in the manual for comprehensive installation instructions.**

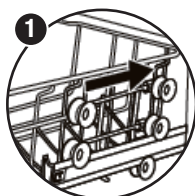

Upper position



Lower position

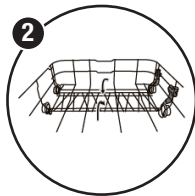

Folded backwards

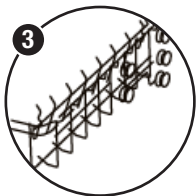

Raised upwards

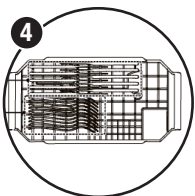

Sliding cutlery tray



Cutlery basket

## B Customising your dishwasher

The height of the upper basket can easily be adjusted in the upper or lower position in order to accommodate taller dishes.

If you need more space for pots and pans in the lower basket, you can fold down the spike rows at the back so that larger or more pots and pans can be loaded.

The cup rack is designed to hold smaller cups or similar lightweight items. To make room for taller items in the upper basket, you can raise it upwards, or remove it when it is not required for use.

Cutlery may be washed in either the sliding cutlery tray (in the upper basket) or cutlery basket (lower basket). Ensure items do not cover each other.

If you use the sliding cutlery tray, please ensure it does not cover other items underneath the tray, and place it in a way so all items on and under the tray will get sprayed with water.

**B**
**1**
**2**
**3**
**4**

# Using your dishwasher

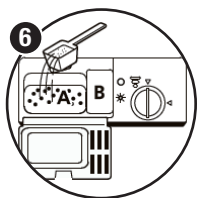
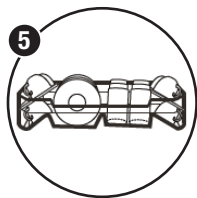
**C**

Open the door and draw out the lower basket. Load your dishes and push the basket back into place. Then load the upper basket the same way.

Add dishwasher detergent and rinse aid (if applicable) according to the instructions.

Close the dishwasher door properly. Press the POWER button on the control panel.

Select the desired wash program using the PROGRAM button, then press START/PAUSE.

At the end of the program, the machine will enter standby state and switch off automatically after 30 minutes if there is no other operation.

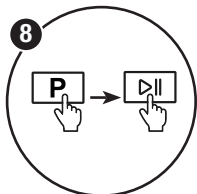
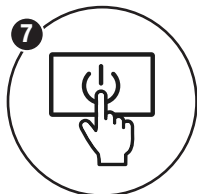

## D Control panel

Press the POWER button to enter or exit the ready-to-use state.

Press the DELAY button to increase the delay start time.

Press the FUNCTION button to select the EXTRA DRYING function and have dishes dried more thoroughly.

Choose the HALF LOAD function when you only have a small load to wash, to save energy and water.

PROGRAM P1 P2 ECO P3 P4 P5 P6 P7

STIRLING

0 0 0



Press the PROGRAM button to select the appropriate washing program.

Press the START/PAUSE button to start the selected washing program or pause it when the dishwasher is working.

Please refer to the instruction manual, pages 10–11, for comprehensive descriptions of all buttons and indicators.

## Give us a call

What? You mean this Quick Start Guide didn't have ALL the answers? The manual has more comprehensive instructions, or speak to us. Call our After Sales Support on 1300 112 534.

Well done, you made it! Now sit back and relax ... your new stainless steel dishwasher is automatically covered by a 3 year warranty.