



Quick Start Guide

Model: STR-TLW70

Let's get your new top load washing machine ready to use!

1 Installing the machine

CAUTION! This washing machine is very heavy – transport it with care! A team lift or mechanical aid is required when moving it.

This washing machine must be installed by a competent person. Installation involves installing the base cover, levelling the machine, connecting it to your cold water supply and installing the drain hose. Please refer to pages 10-13 in the instruction manual for comprehensive instructions.

NOTE: Before using the washing machine for the first time, run a complete cycle without laundry items and detergent on the **NORMAL** program following the instructions on page 16 in the manual.

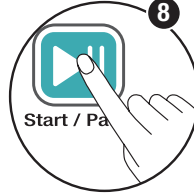
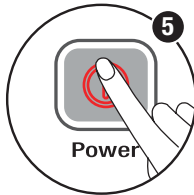
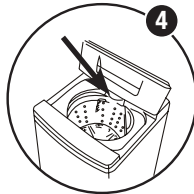
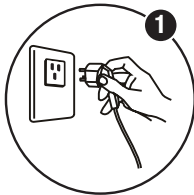

Preparation

1 Plug in the machine.

2 Open your water taps.

3 Load your washing into the machine – page 16 in the instruction manual has useful hints to help you with this.

4 Add detergent to the detergent box – find all the details on page 17 in the instruction manual.

Washing

5 Press the Power On/Off button.

6 Select a program – all program details are provided on page 17 in the instruction manual.

7 This is also the time to adjust wash process details, if you wish (see point 5, over the page).

8 Close the lid and press the Start/Pause button.

Nearly done! Just a bit more on the other side of this page...

Afterwards

4

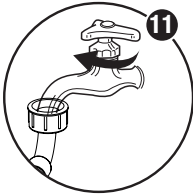
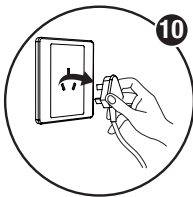

At the end of the wash, open the lid and take your washing out of the washing tub. The machine will switch off automatically.

Remove the power plug from the wall outlet.

Close the water taps.

We recommend you leave the lid open so the tub can dry properly and to prevent mould and odour development.

5 Wash programs

The washing machine is equipped with multiple wash programs and water levels, electronic controls and digital display, a load sensor and 24-hour timer.

The scoop indicators show how much powder detergent to use.

The option indicators show the set wash process (delay, soak, wash, rinse, spin).

The digital display shows the remaining time or error messages.

The program indicators show the selected program.

The water indicator shows the water temperature: flashing for hot, glowing steadily for warm and off for cold water.

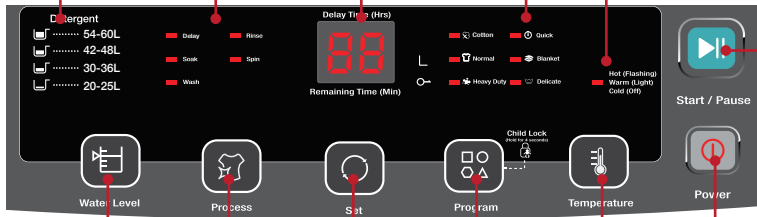

Use the Water Level button to select the water level appropriate for your load size.

First, use the Process button to select the process (delay, soak, or wash, rinse or spin times), then use the Set button to select the option.

Use the Program button to select the wash program.

Use the Temperature button to choose a water temperature.

Use the Power button to switch on the power, or press it twice to change a program selection.

Use the Start button to start or pause operation.

Give us a call

What? You mean this Quick Start Guide didn't have ALL the answers? The manual has more comprehensive instructions, or speak to us. Call our **After Sales Support** on **1300 886 649**.

Well done, you made it! Now sit back and relax ... your new top load washing machine is automatically covered by a 3 year warranty.